

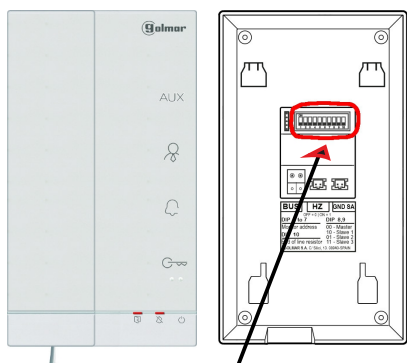

ASIGNACIÓN CÓDIGOS LLAMADA EN TERMINALES VIVIENDAS

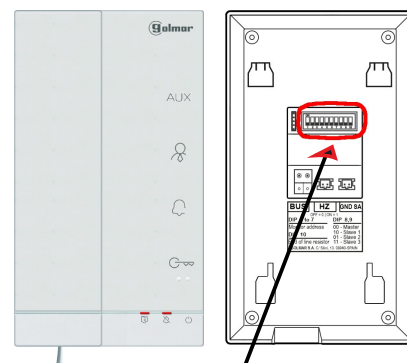

POSICION DIP TERMINAL



POSICION DIP TERMINAL

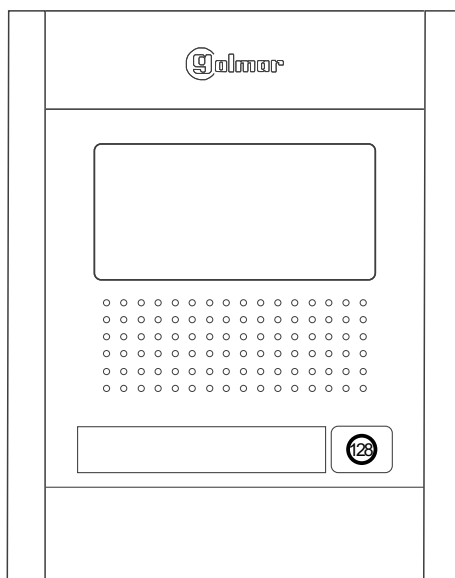



ASIGNACIÓN CÓDIGOS LLAMADA EN TERMINALES VIVIENDAS

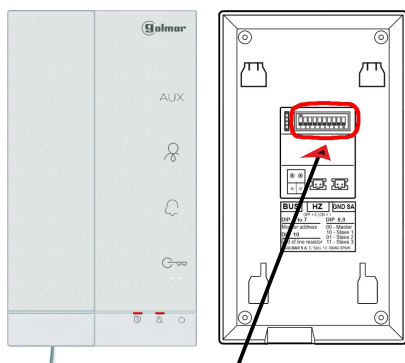

POSICION DIP TERMINAL

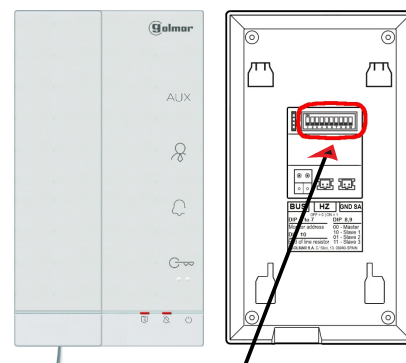

POSICION DIP TERMINAL

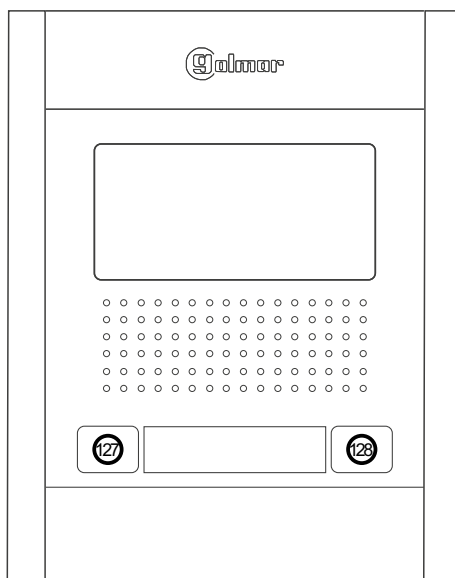



ASIGNACIÓN CÓDIGOS LLAMADA EN TERMINALES VIVIENDAS

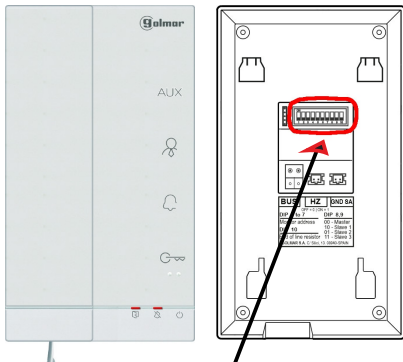

POSICION DIP TERMINAL

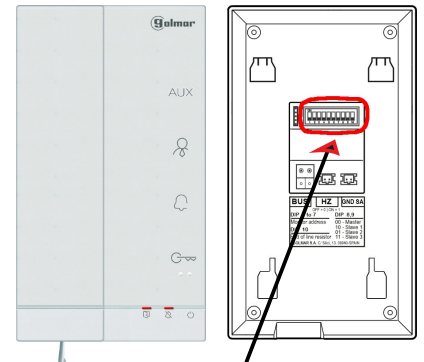

POSICION DIP TERMINAL

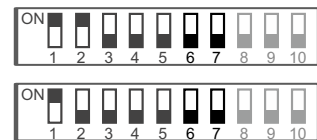
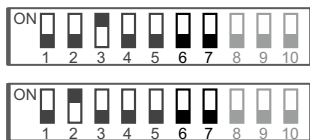
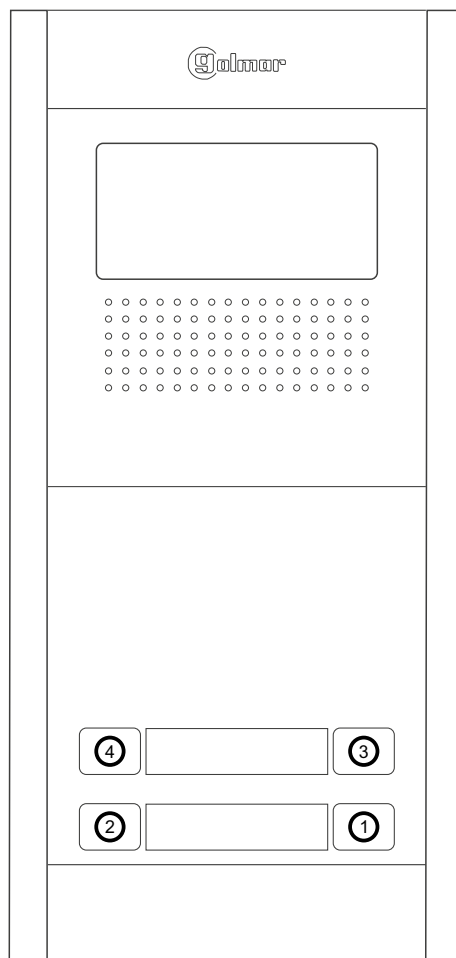



ASIGNACIÓN CÓDIGOS LLAMADA EN TERMINALES VIVIENDAS

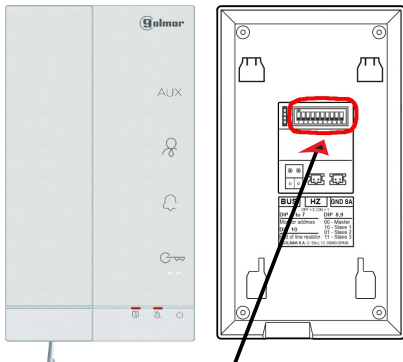

POSICION DIP TERMINAL

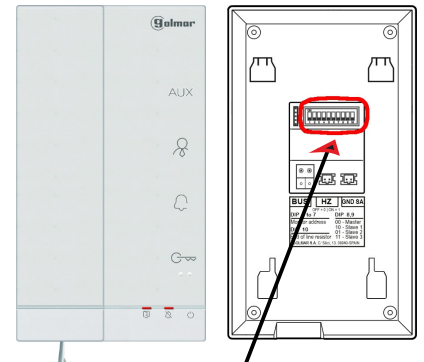

POSICION DIP TERMINAL

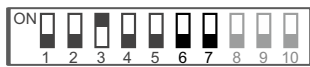
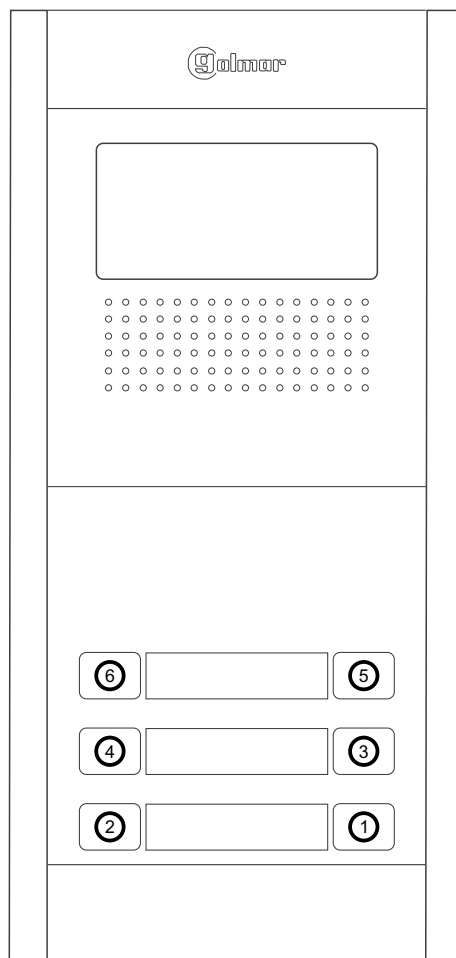



ASIGNACIÓN CÓDIGOS LLAMADA EN TERMINALES VIVIENDAS

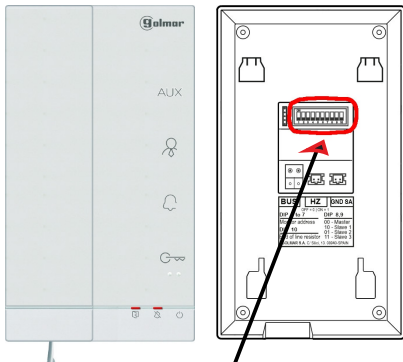

POSICION DIP TERMINAL

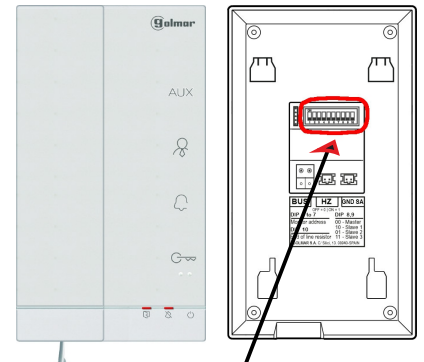

POSICION DIP TERMINAL

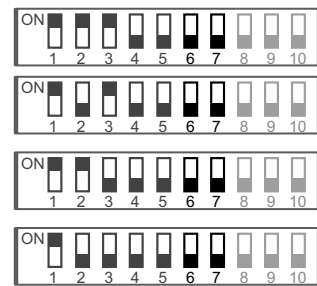
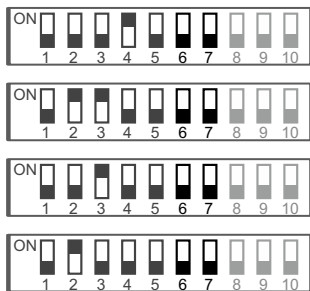
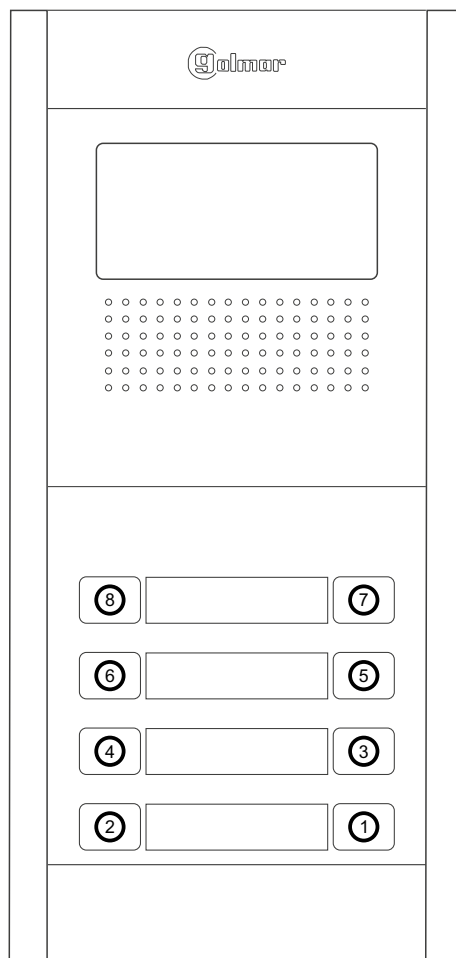



ASIGNACIÓN CÓDIGOS LLAMADA EN TERMINALES VIVIENDAS

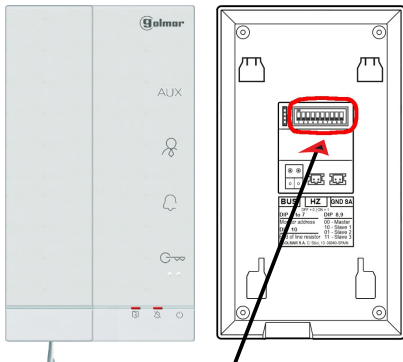

POSICION DIP TERMINAL

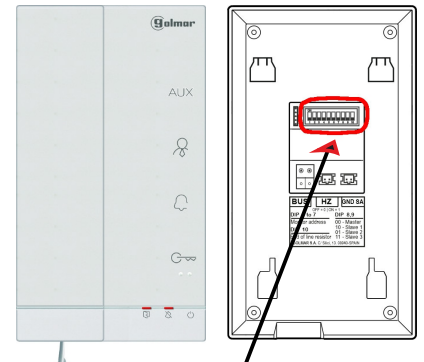

POSICION DIP TERMINAL

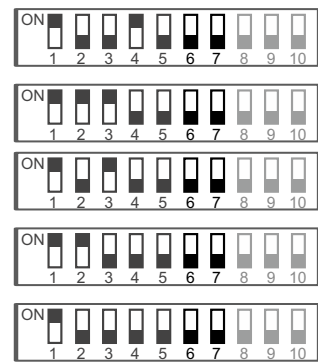
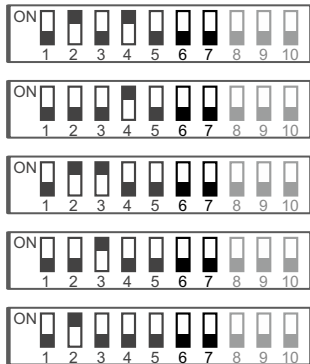
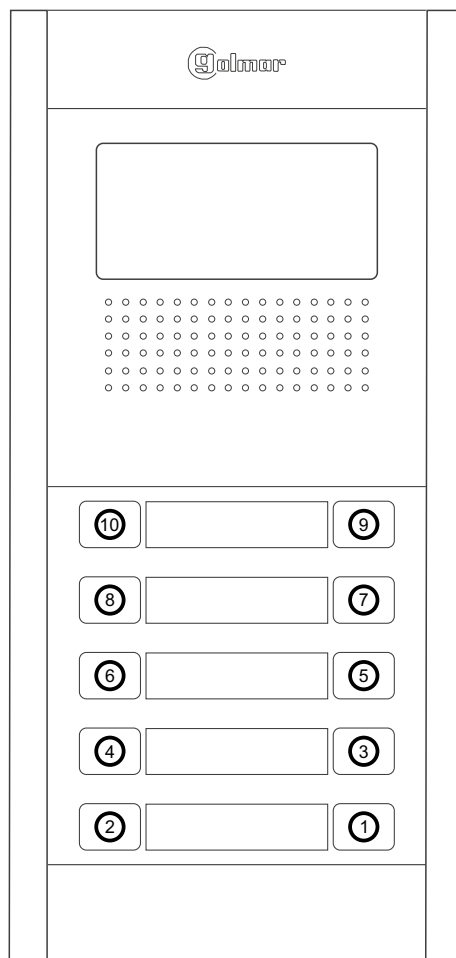



ASIGNACIÓN CÓDIGOS LLAMADA EN TERMINALES VIVIENDAS

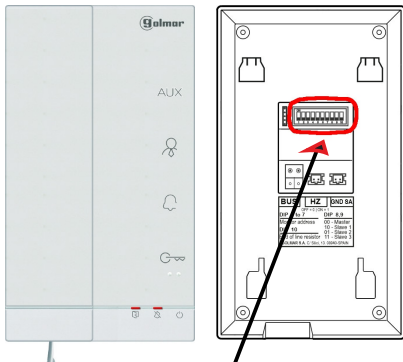

POSICION DIP TERMINAL

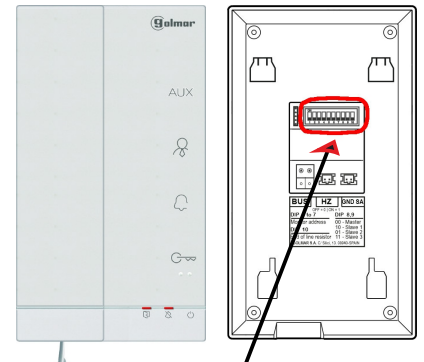

POSICION DIP TERMINAL

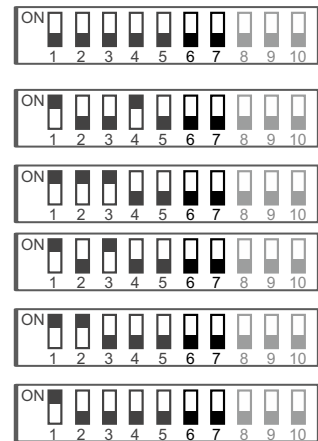
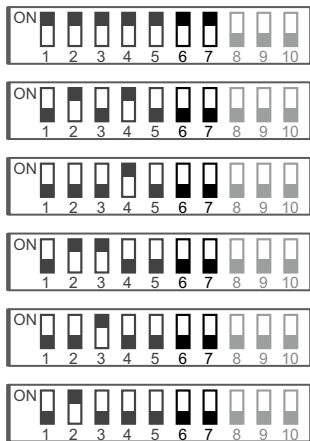
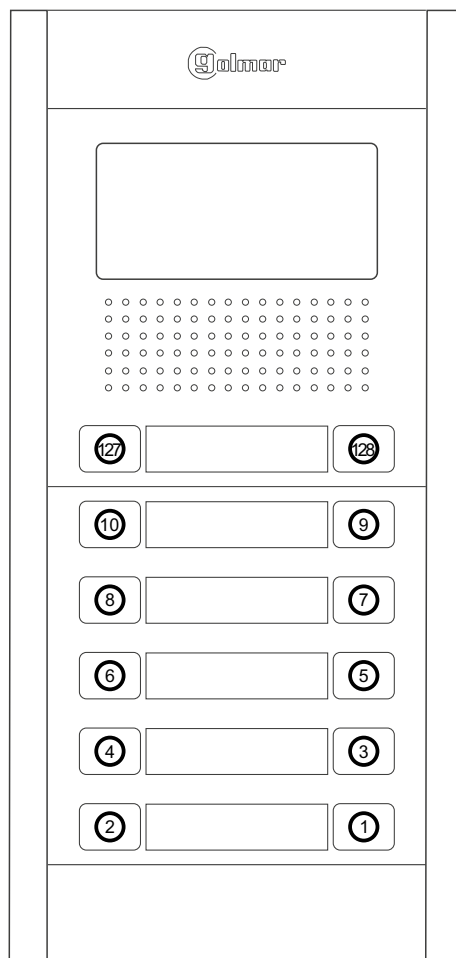



ASIGNACIÓN CÓDIGOS LLAMADA EN TERMINALES VIVIENDAS

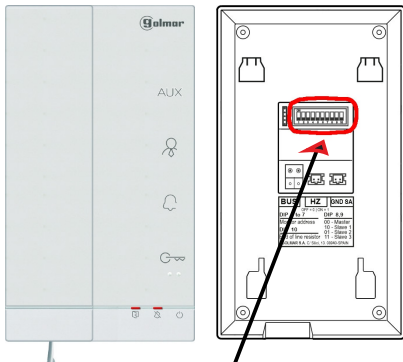

POSICION DIP TERMINAL

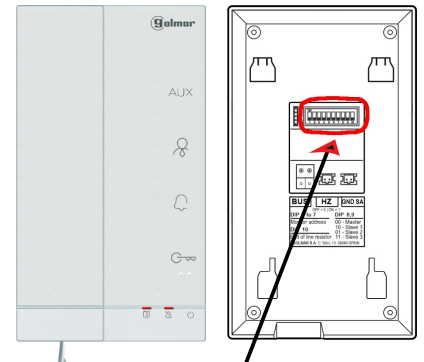

POSICION DIP TERMINAL

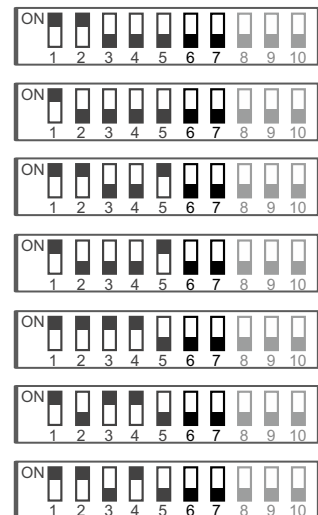
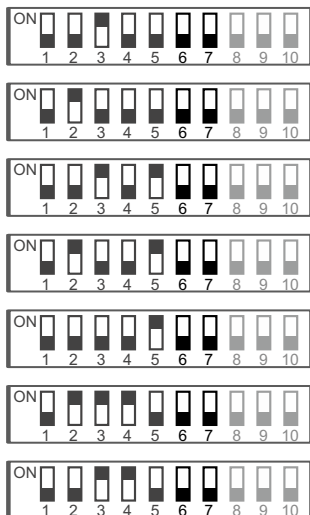
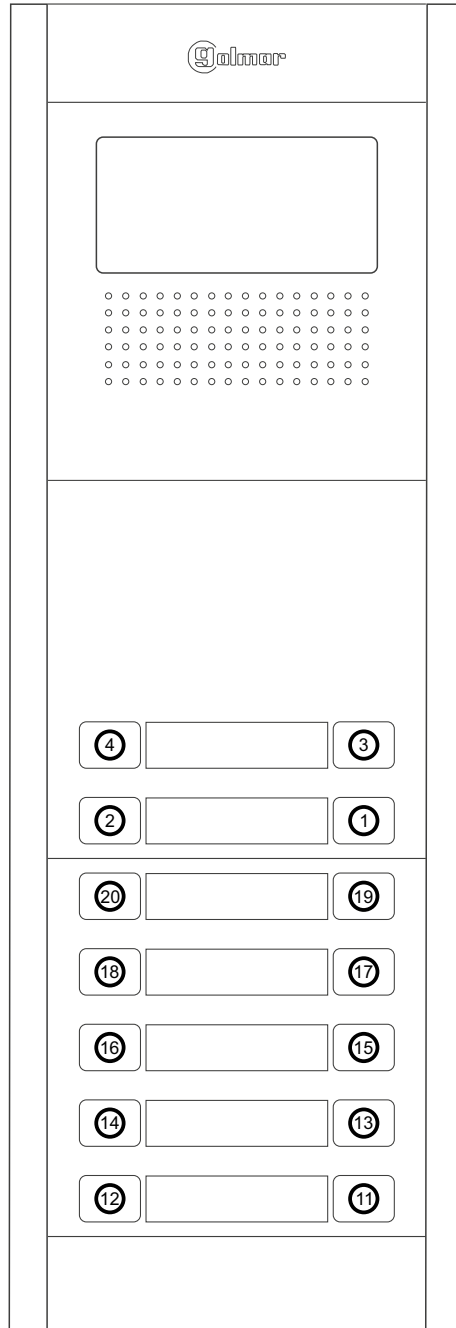



ASIGNACIÓN CÓDIGOS LLAMADA EN TERMINALES VIVIENDAS

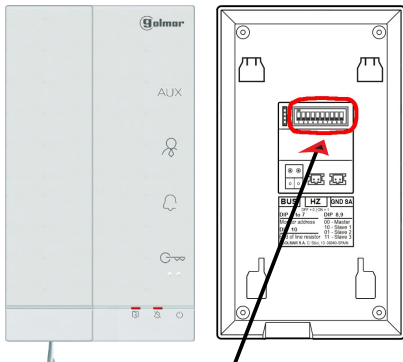

POSICION DIP TERMINAL

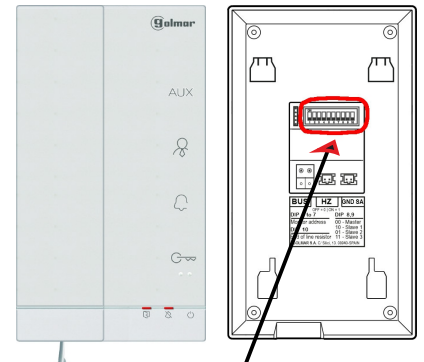

POSICION DIP TERMINAL

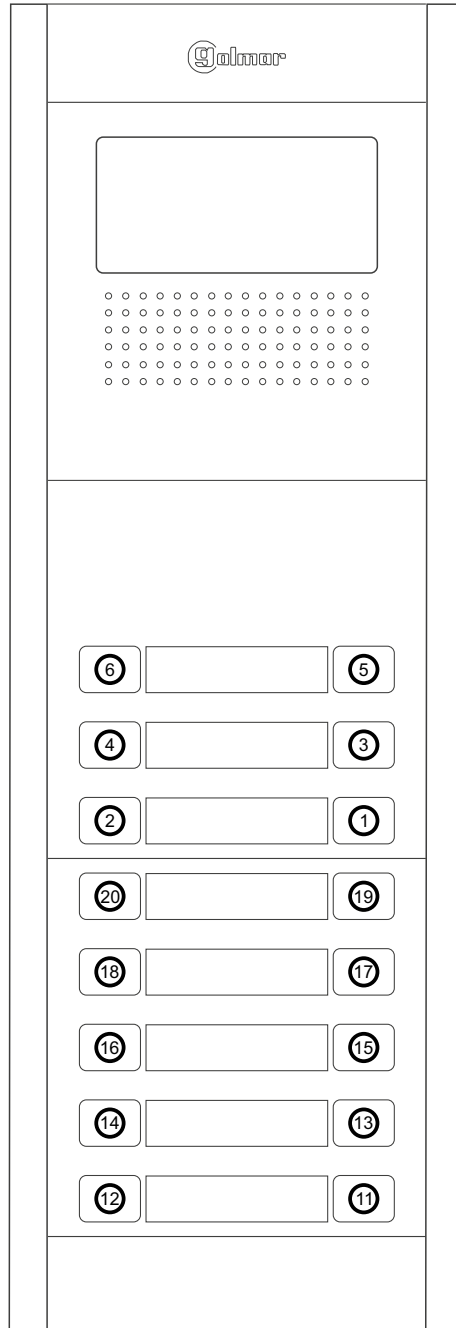



ASIGNACIÓN CÓDIGOS LLAMADA EN TERMINALES VIVIENDAS

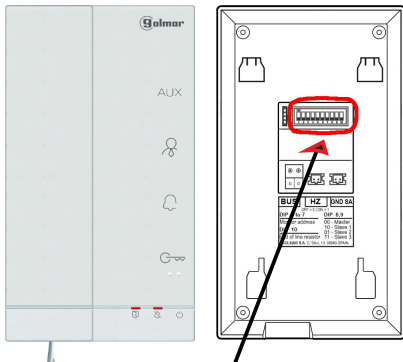

POSICION DIP TERMINAL

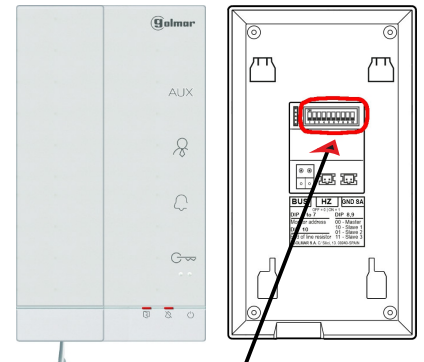

POSICION DIP TERMINAL

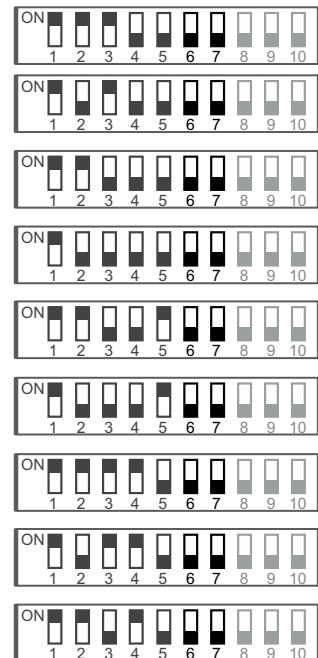
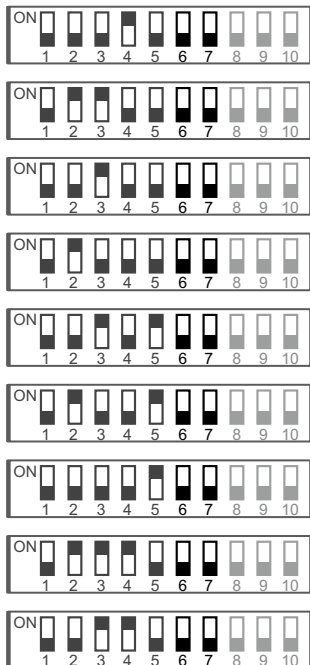
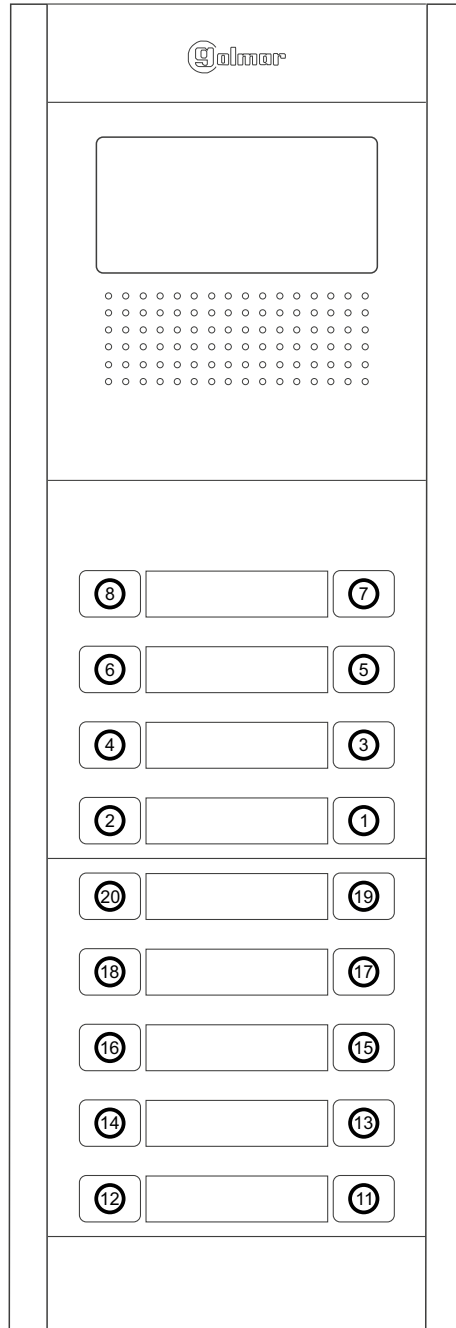



ASIGNACIÓN CÓDIGOS LLAMADA EN TERMINALES VIVIENDAS

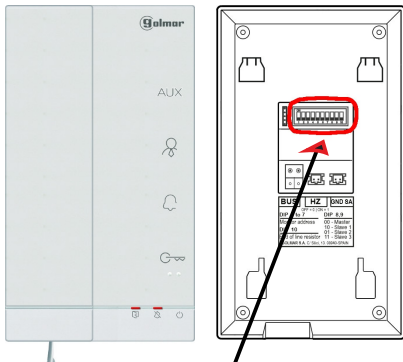

POSICION DIP TERMINAL

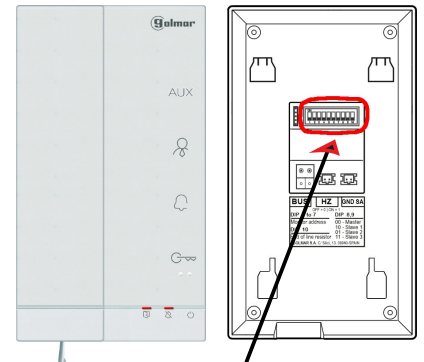

POSICION DIP TERMINAL

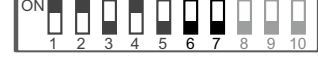
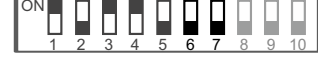
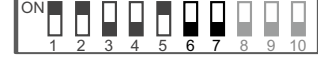
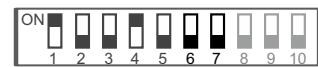
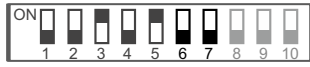
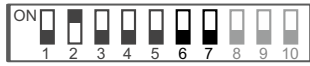
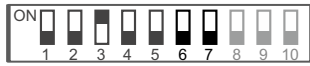
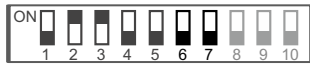
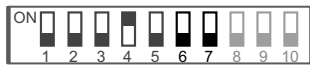
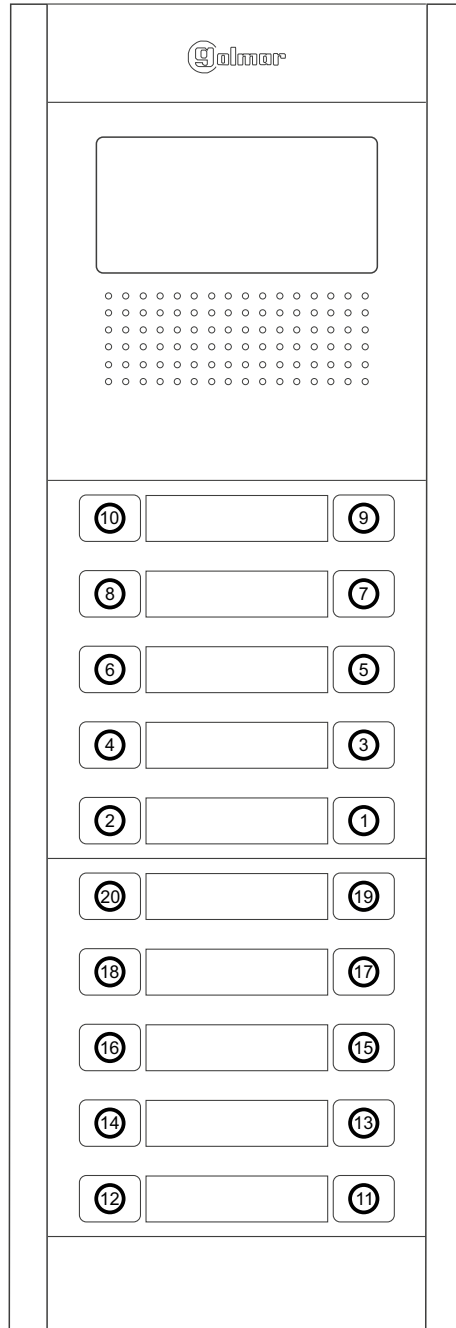



ASIGNACIÓN CÓDIGOS LLAMADA EN TERMINALES VIVIENDAS

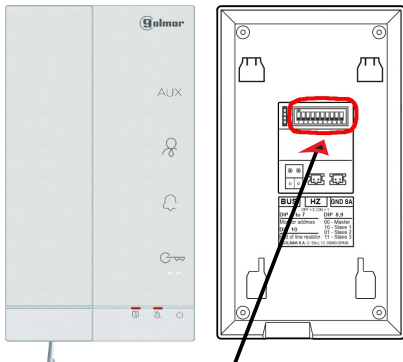

POSICION DIP TERMINAL

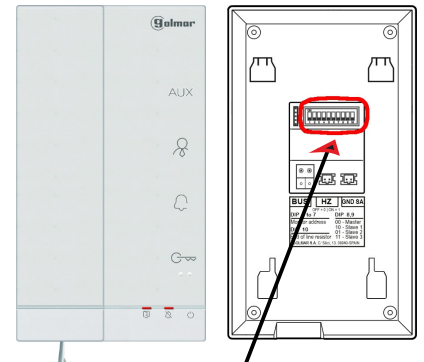

POSICION DIP TERMINAL

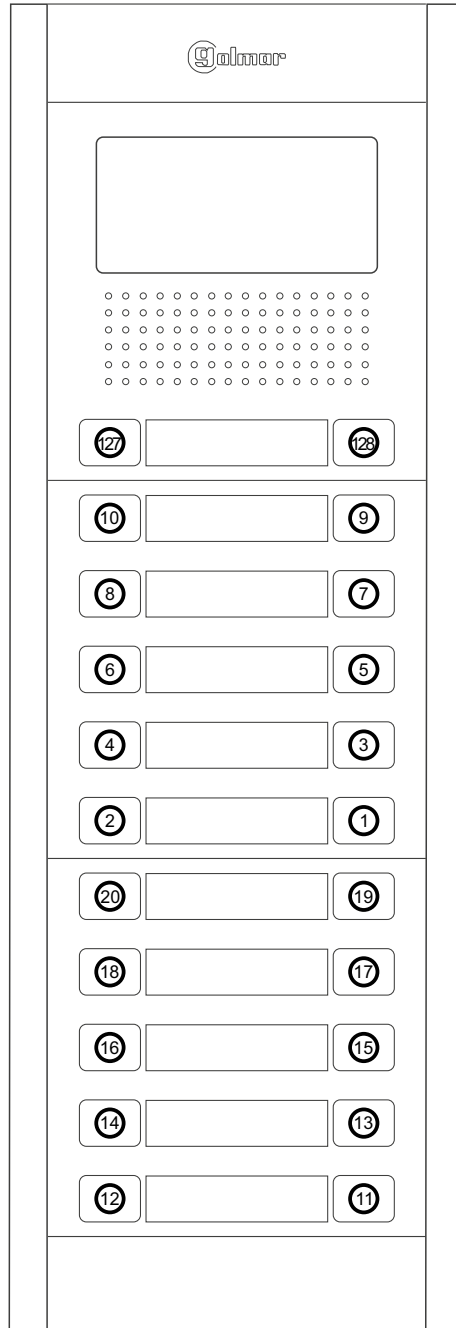



ESQUEMA CONEXIONADO

Instalación hasta 128 viviendas/terminales de audio T-ART/G2+ y abrepuertas de continua Golmar.

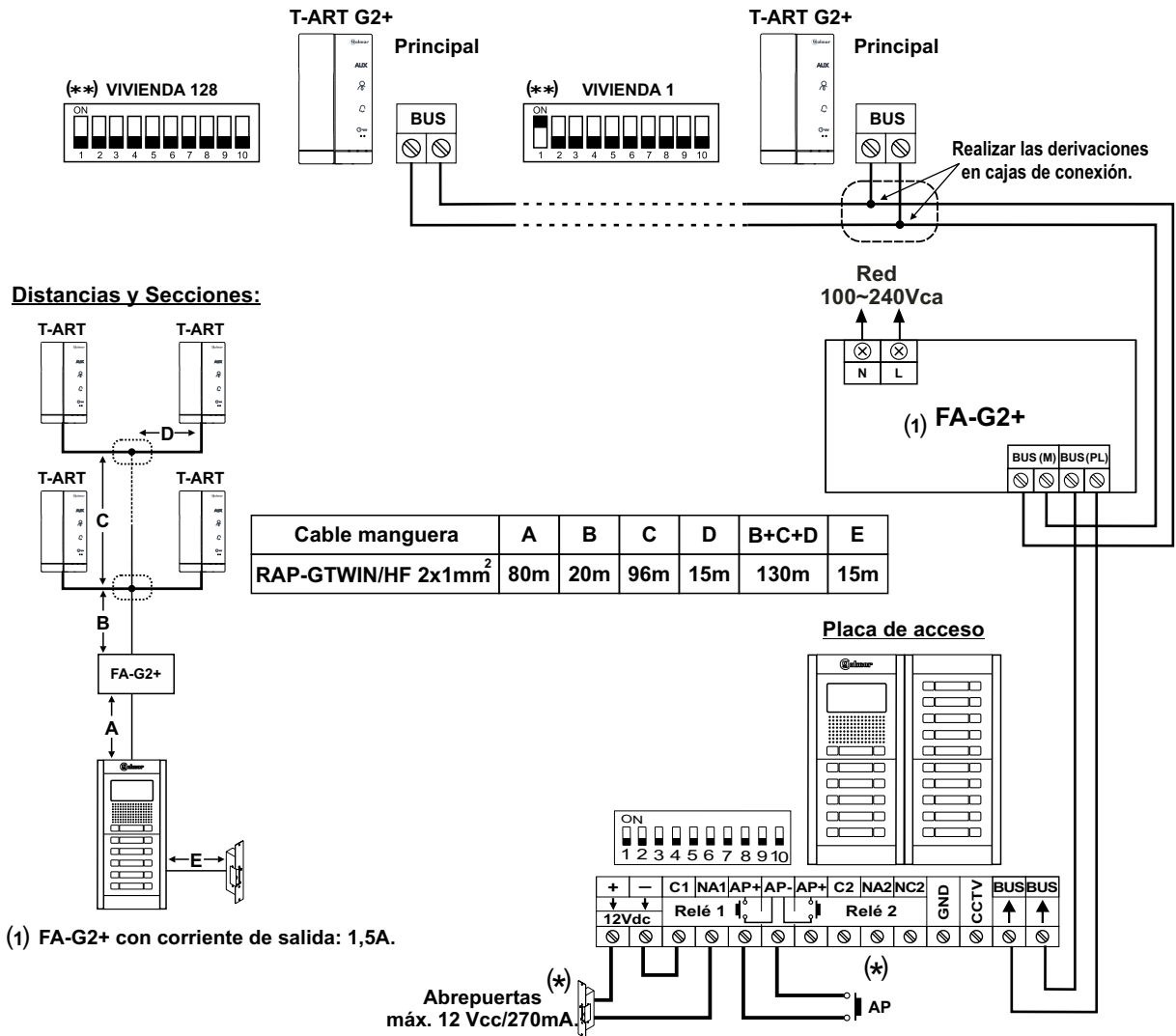

(**) Instalación solo audio, configurar Resistencia Final de Línea DIP10 a OFF en todos los terminales de audio
 (*) Para más información ver manual de usuario "TT-ART/G2+ (cód. 50122719)".
<https://doc.golmar.es/search/manual/50122719>