

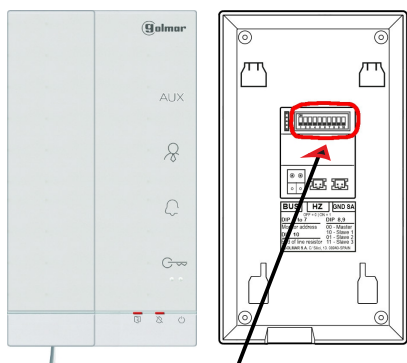

ASIGNACIÓN CÓDIGOS LLAMADA EN MONITORES VIVIENDAS

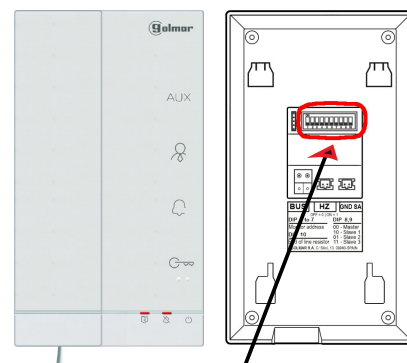

POSICION DIP MONITOR



POSICION DIP MONITOR

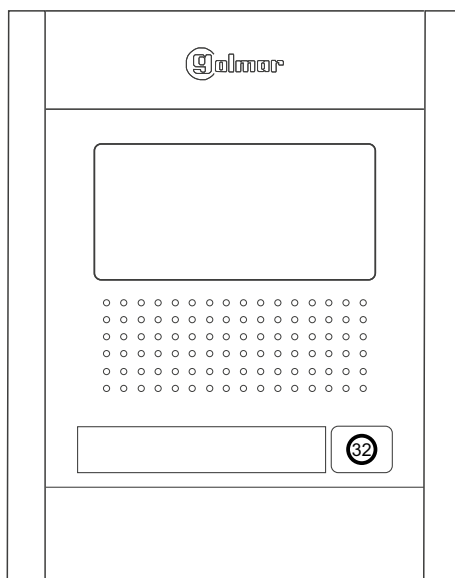



ASIGNACIÓN CÓDIGOS LLAMADA EN MONITORES VIVIENDAS

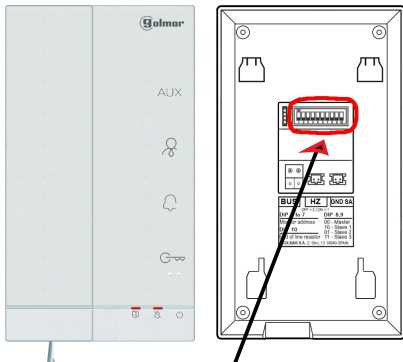

POSICION DIP MONITOR

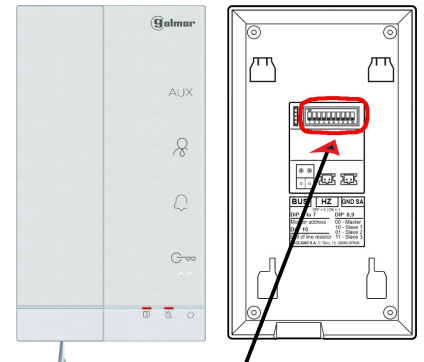

POSICION DIP MONITOR

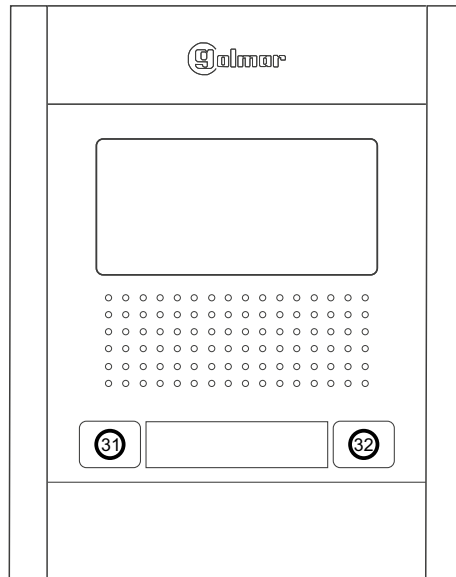



ASIGNACIÓN CÓDIGOS LLAMADA EN MONITORES VIVIENDAS

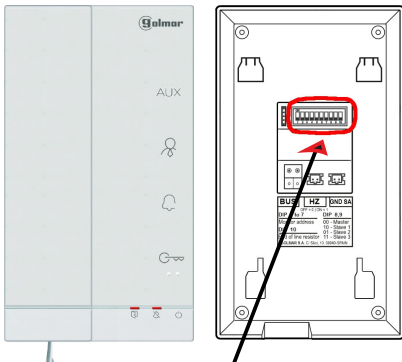

POSICION DIP MONITOR

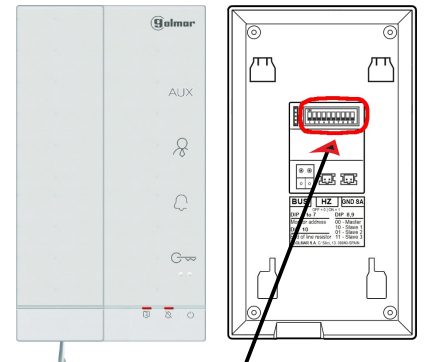

POSICION DIP MONITOR

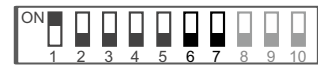
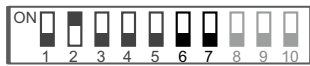
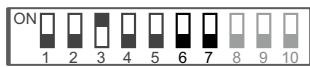
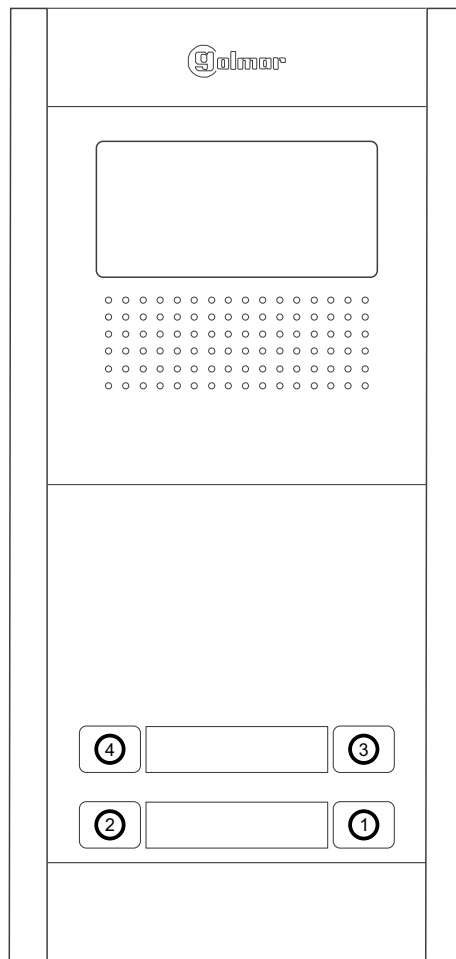



ASIGNACIÓN CÓDIGOS LLAMADA EN MONITORES VIVIENDAS

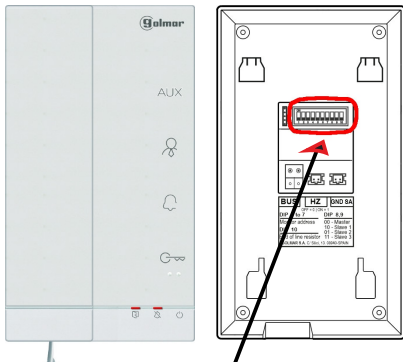

POSICION DIP MONITOR

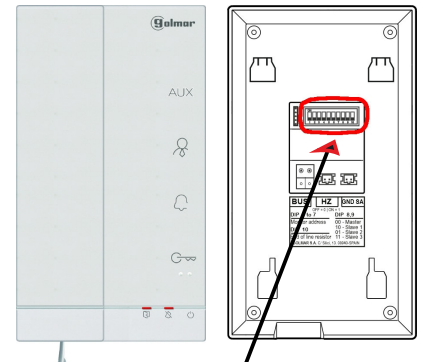

POSICION DIP MONITOR

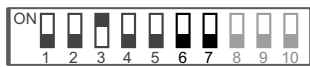
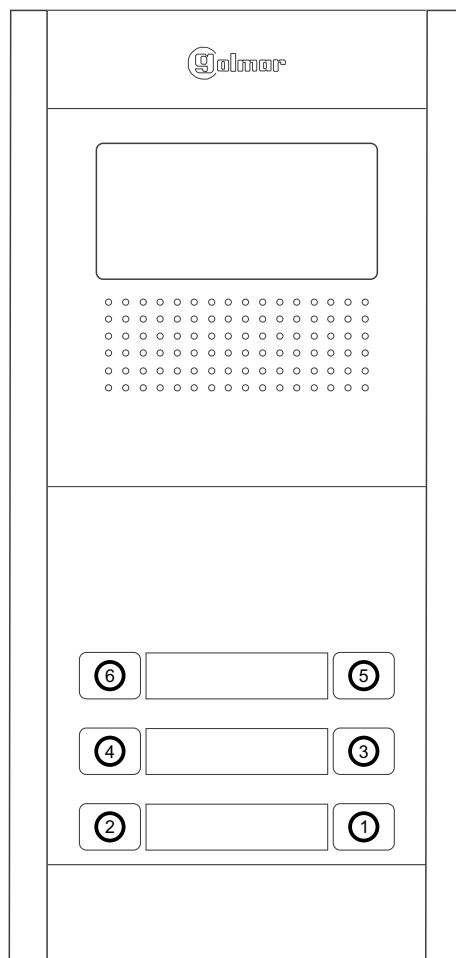



ASIGNACIÓN CÓDIGOS LLAMADA EN MONITORES VIVIENDAS

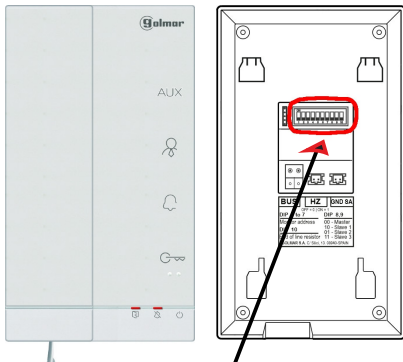

POSICION DIP MONITOR

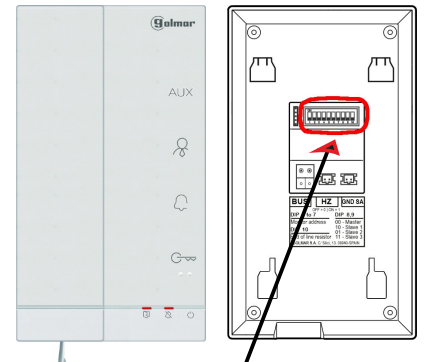

POSICION DIP MONITOR

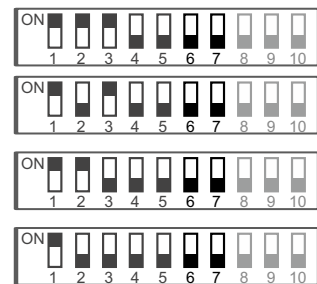
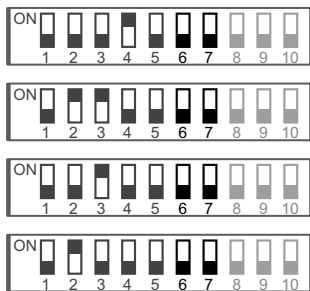
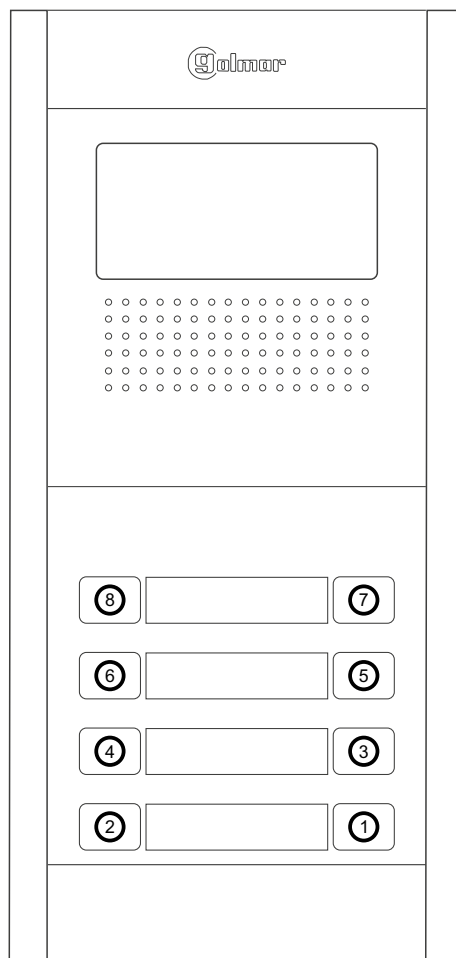



ASIGNACIÓN CÓDIGOS LLAMADA EN MONITORES VIVIENDAS

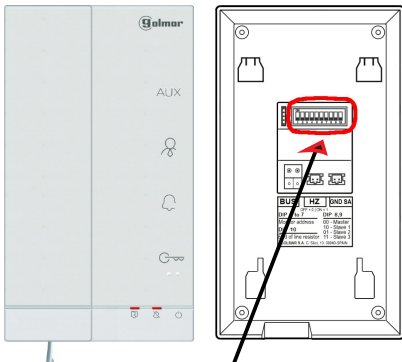

POSICION DIP MONITOR

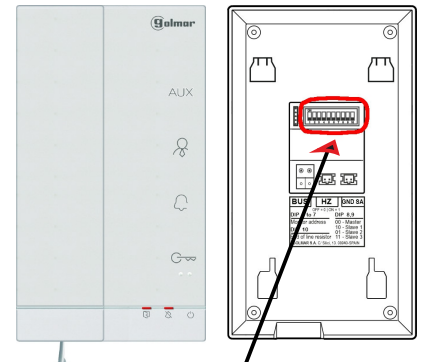

POSICION DIP MONITOR

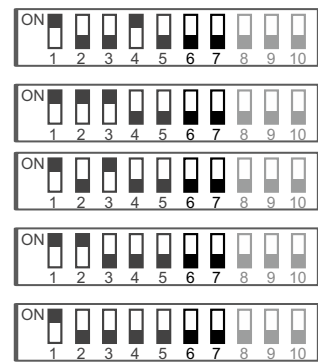
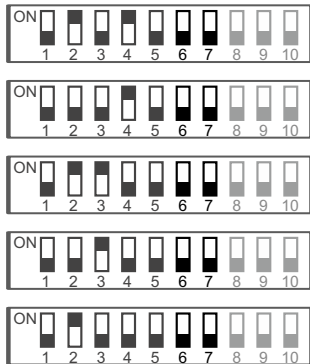
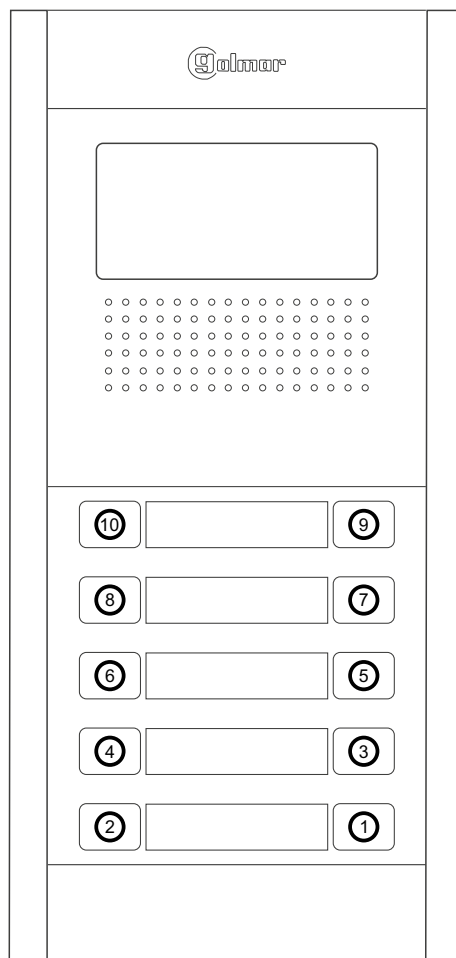



ASIGNACIÓN CÓDIGOS LLAMADA EN MONITORES VIVIENDAS

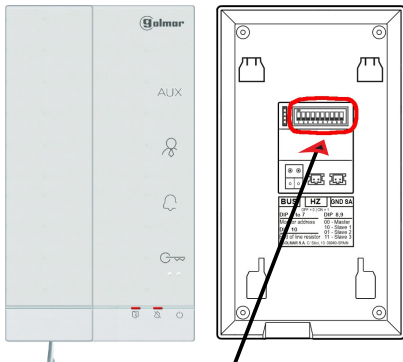

POSICION DIP MONITOR

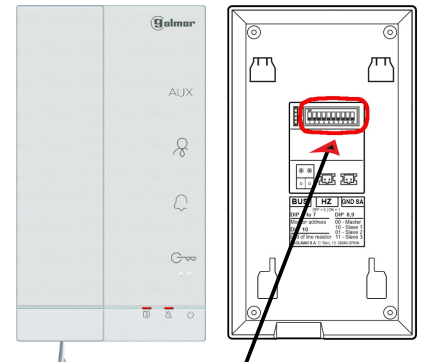

POSICION DIP MONITOR

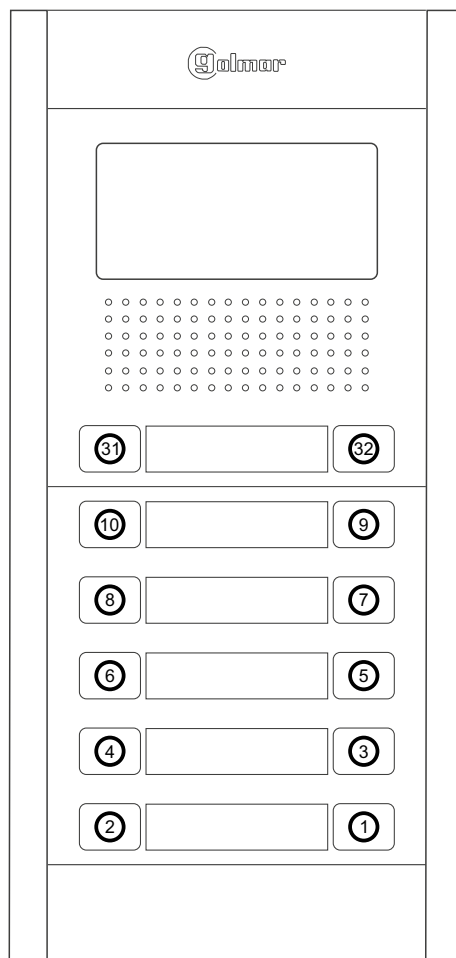



ASIGNACIÓN CÓDIGOS LLAMADA EN MONITORES VIVIENDAS

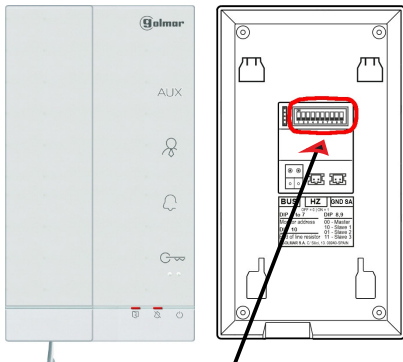

POSICION DIP MONITOR

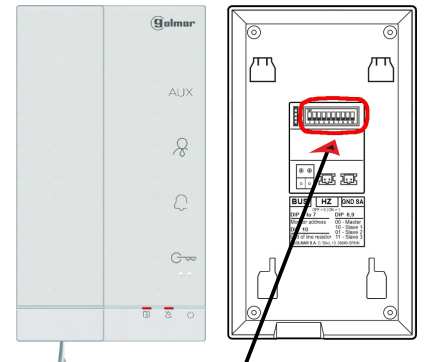

POSICION DIP MONITOR

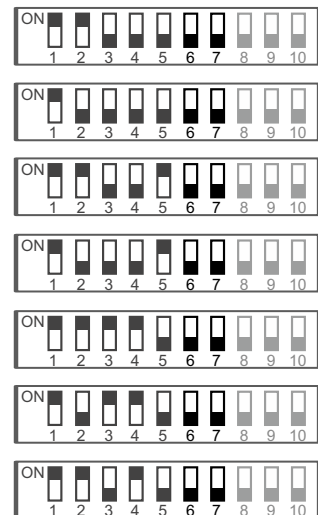
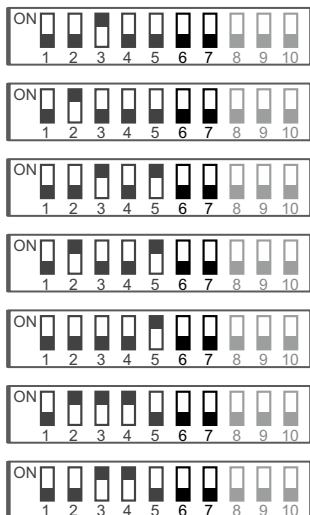
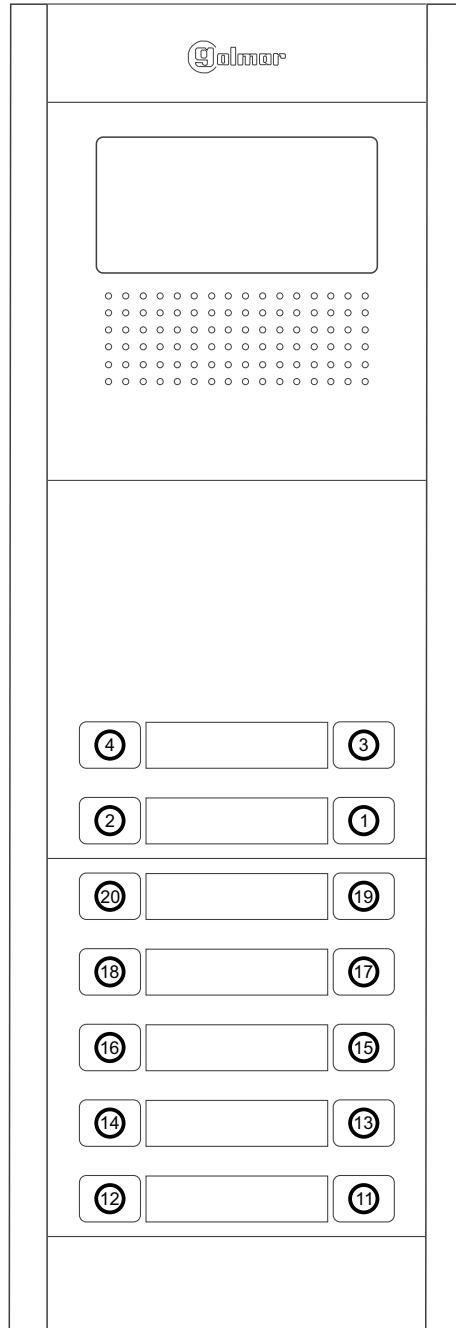



ASIGNACIÓN CÓDIGOS LLAMADA EN MONITORES VIVIENDAS

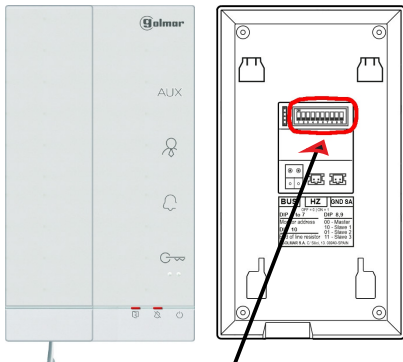

POSICION DIP MONITOR

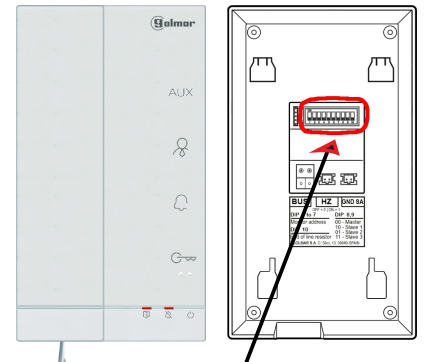

POSICION DIP MONITOR

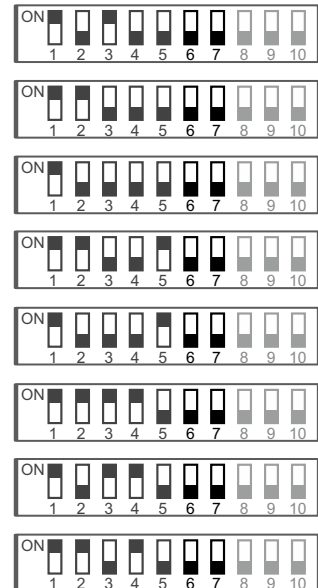
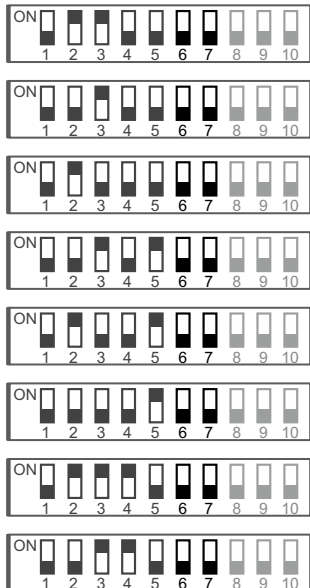
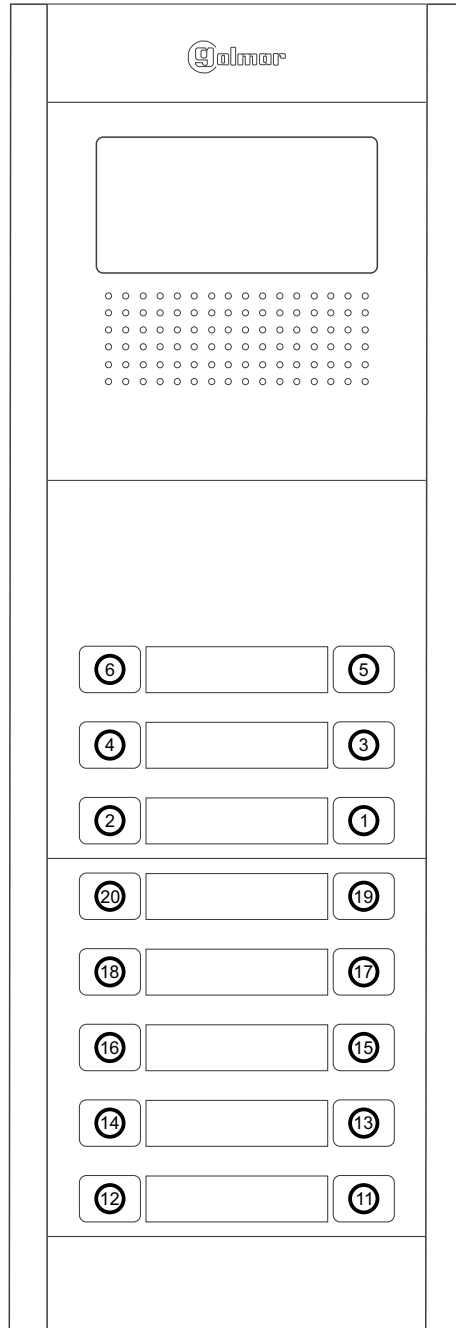



ASIGNACIÓN CÓDIGOS LLAMADA EN MONITORES VIVIENDAS

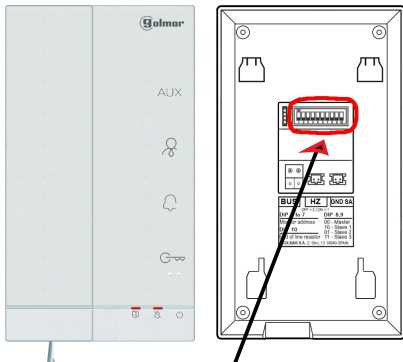

POSICION DIP MONITOR

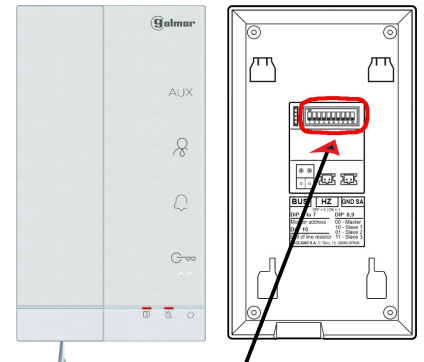

POSICION DIP MONITOR

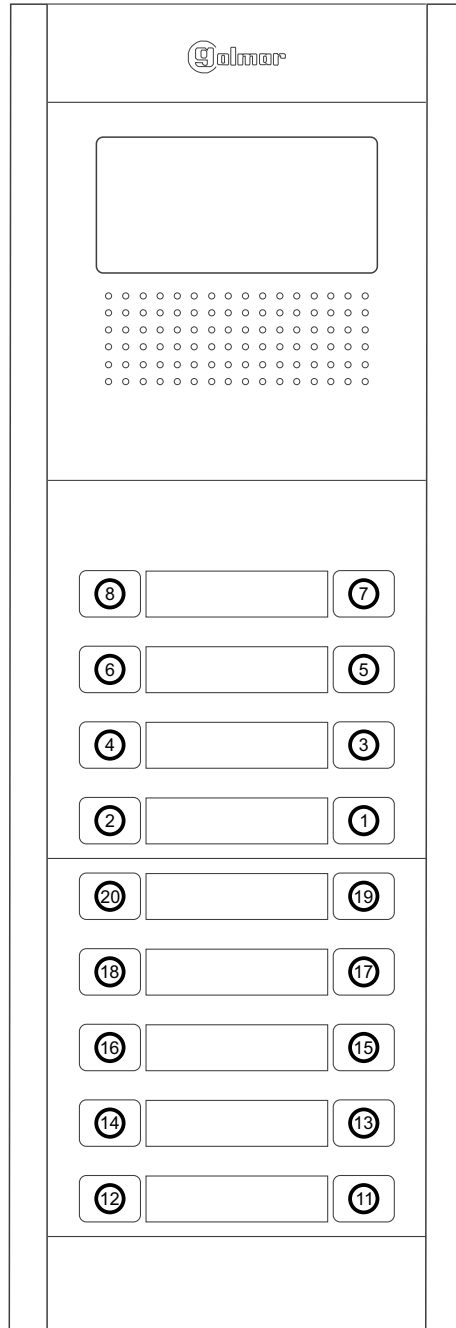



ASIGNACIÓN CÓDIGOS LLAMADA EN MONITORES VIVIENDAS

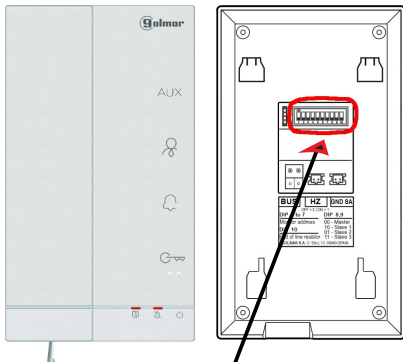

POSICION DIP MONITOR

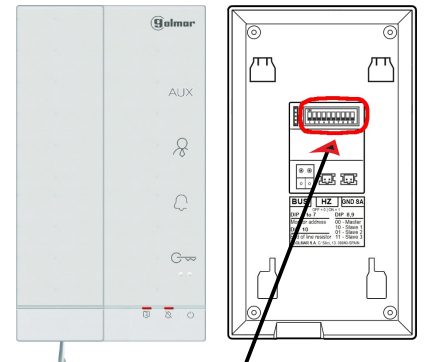

POSICION DIP MONITOR

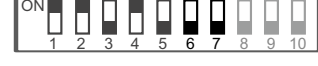
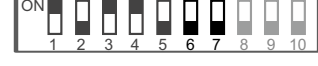
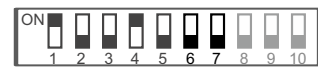
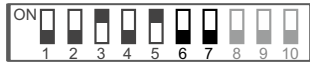
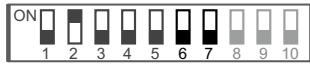
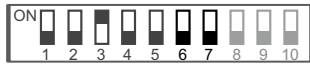
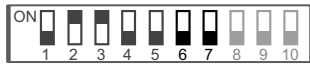
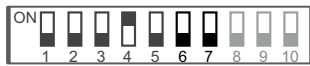
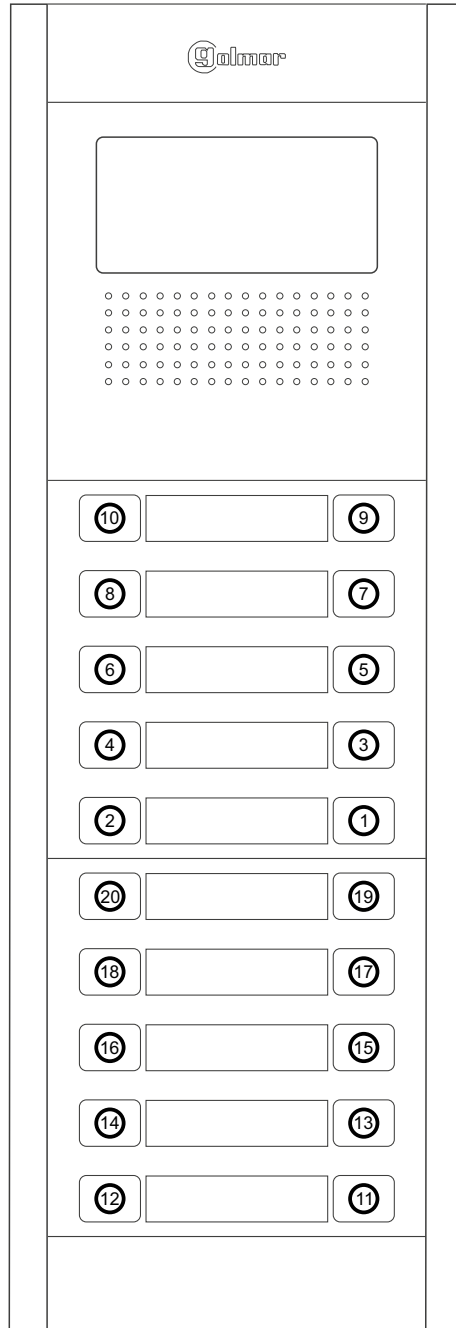



ASIGNACIÓN CÓDIGOS LLAMADA EN MONITORES VIVIENDAS

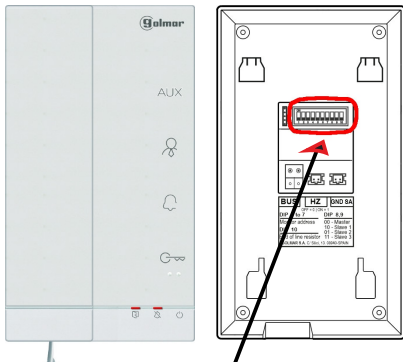

POSICION DIP MONITOR

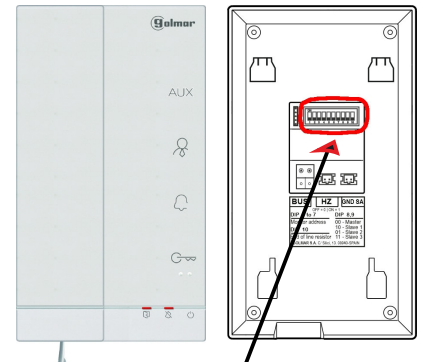

POSICION DIP MONITOR

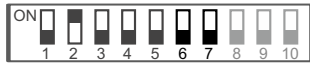
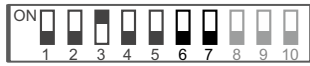
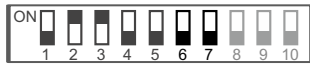
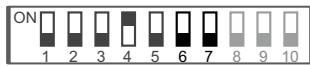
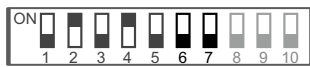
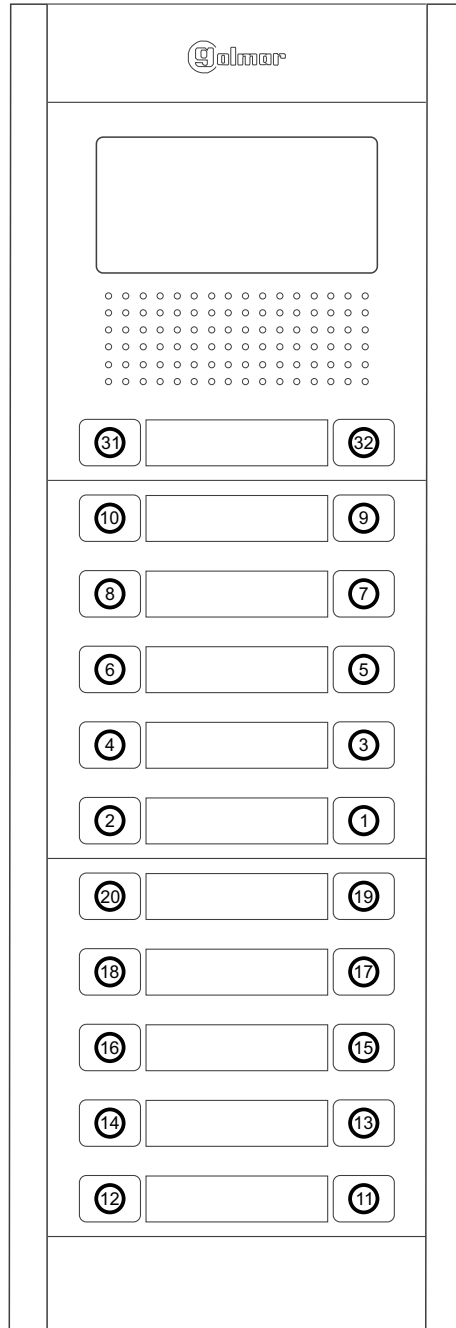



ESQUEMA CONEXIONADO

Instalación hasta 128 viviendas/teléfonos T-ART/G2+ y abrepuestas de continua Golmar.

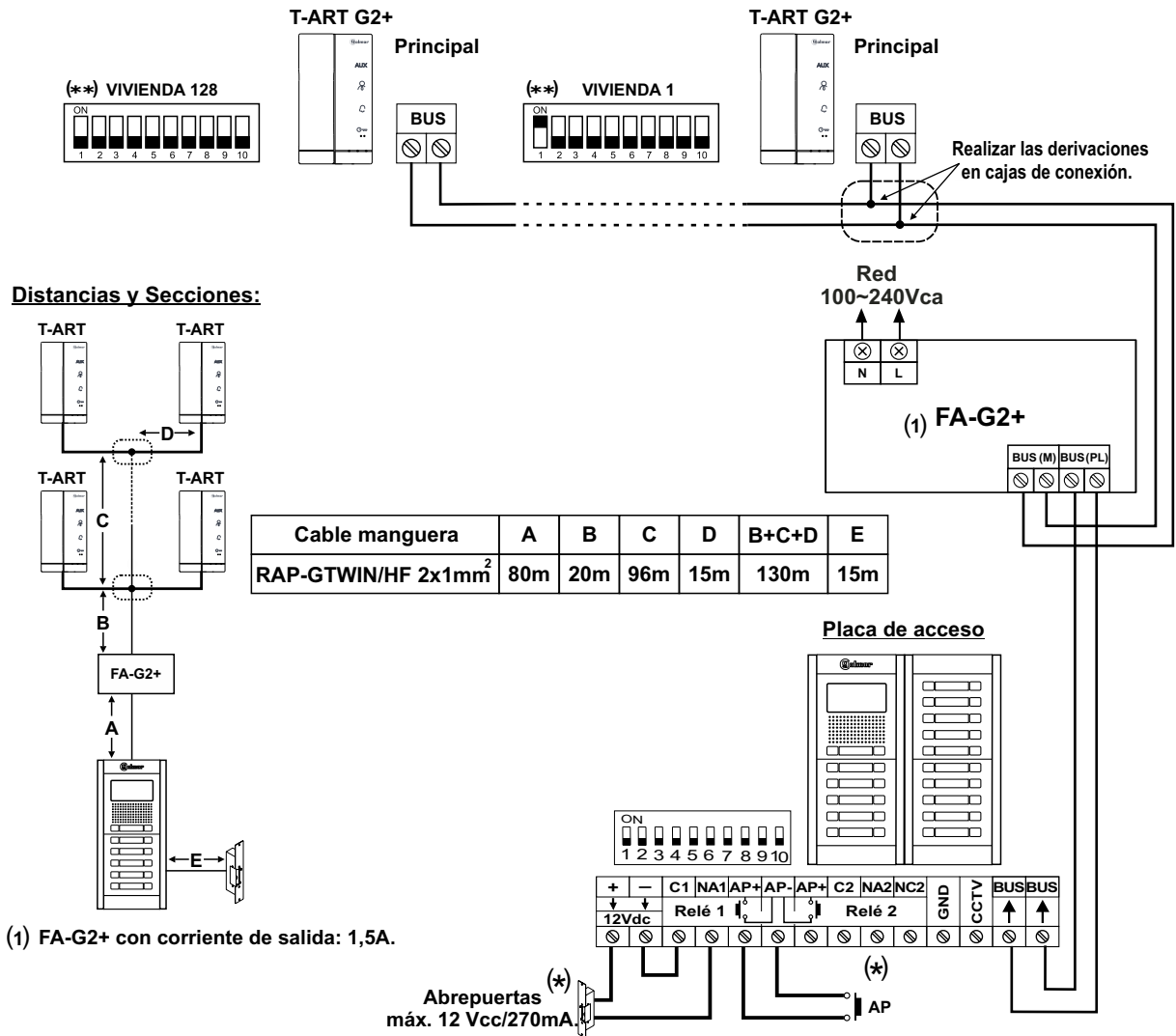

(**) Instalación solo audio, configurar Resistencia Final de Línea DIP10 a OFF en todos los teléfonos
 (*) Para más información ver manual de usuario "TT-ART/G2+ (cód. 50122719)".
<https://doc.golmar.es/search/manual/50122719>